



LOKNETE DR. BALASAHEB VIKHE PATIL
(PADMA BHUSHAN AWARDEE)
PRAVARA RURAL EDUCATION SOCIETY
ARTS, SCIENCE & COMMERCE COLLEGE
KOLHAR

Tal. Rahata, Dist. Ahmednagar, Pin - 413 710
NAAC Accredited at 'A' Grade with CGPA 3.10

Key Indicator - 4.1 Physical Facilities

4.1.1 The Institution has adequate infrastructure and physical facilities for teaching- learning. viz., classrooms, laboratories, computing equipment etc.

Infrastructure Facilities

Site	Name	Particulars / Cell	Available Area (Sq. ft.)
Ground Floor	G 1	Principal Office with WC	1200
	G 1	NAAC office / IQAC with WC	
	G 1	Pantry	
	G 1	Waiting Lobby	
	G 2	Administrative Office (OS, Account , Vice Principal)	600
	G 2	Store Room / Record Room	600
	G 3	Girls Common Room /Sick Room with 1 WC and 1 WC for Divyanjan	
	G 3	Women Empowerment Cell	
	G 3	Lady Vice Principal	
	G 4	Student Section (Scholarship, Examination and Admission)	300
	G 5	Chemistry Lab -1	1200
	G 6	Chemistry Lab -2 and 3	1200
	GF Corridor 1	Chemistry HoD and Staff Room	320
	GF Corridor 1	Placement Cell	
First Floor	F 1	Zoology	1200
	F 2	Botany Lab	1200
	F 2	Skill Development Cell	
	F 3	Exam Department	300
	F 4	Computer Lab	1200
	F 4	Reading Room	+ 400 Corridor
	F 5	Central Library	1200
	FF Corridor 1	Alumni Cells & SWO	200

	FF Corridor 2	Competitive Exam Cell & Reservation Cell	320
Second Floor	S 1	English Lab	600
	S 1	Smart Class Room	600
	SF Corridor 1	HOD Cabins (Marathi, Hindi, Politics Departments)	320
	SF Corridor 2	HOD Cabins (History, Economics Departments) &1 Cell	320
	S 2	Lecture Hall	600
	S 3	Geography Lab	600
	S 4	Senior College Staff Room	300
	S 5	Physics lab	1200
	S 6	Mathematics Dept.	
	S 7	Lecture Hall	1200
Third Floor	T 1	Lecture Hall	1200
	T 2	Lecture Hall	600
	T 3	Lecture Hall	600
	T 4	Lecture Hall	300
	T 5	Lecture Hall	600
	T 6	Lecture Hall	600
	T 7	Lecture Hall	1200
	TF Corridor 1	HOD Cabins (Commerce Staff Room)	320
	TF Corridor 2	Jr. Staff Room	320
In Campus	In Campus	Gymnasium	1500
	In Campus	Canteen	1000
	In Campus	Student Facilitation Center	
	In Campus	Pravara Bank Ext. Counter	
	In Campus	NSS	
	In Campus	Earn and Learn	
	In Campus	WC	
Total			25420 sq ft

Building Plan :

Master Plan :

PRODUCED BY AN AUTODESK EDUCATIONAL PRODUCT

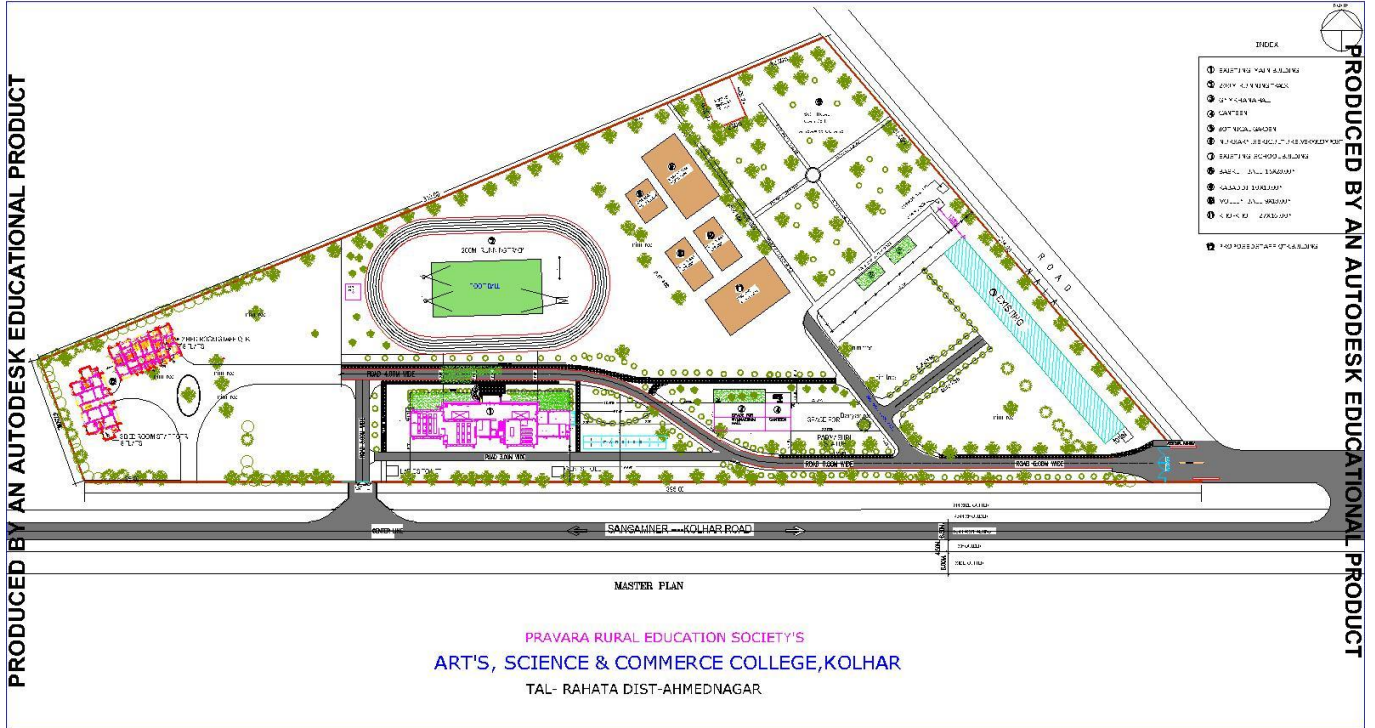

Ground Floor :

PRODUCED BY AN AUTODESK EDUCATIONAL PRODUCT

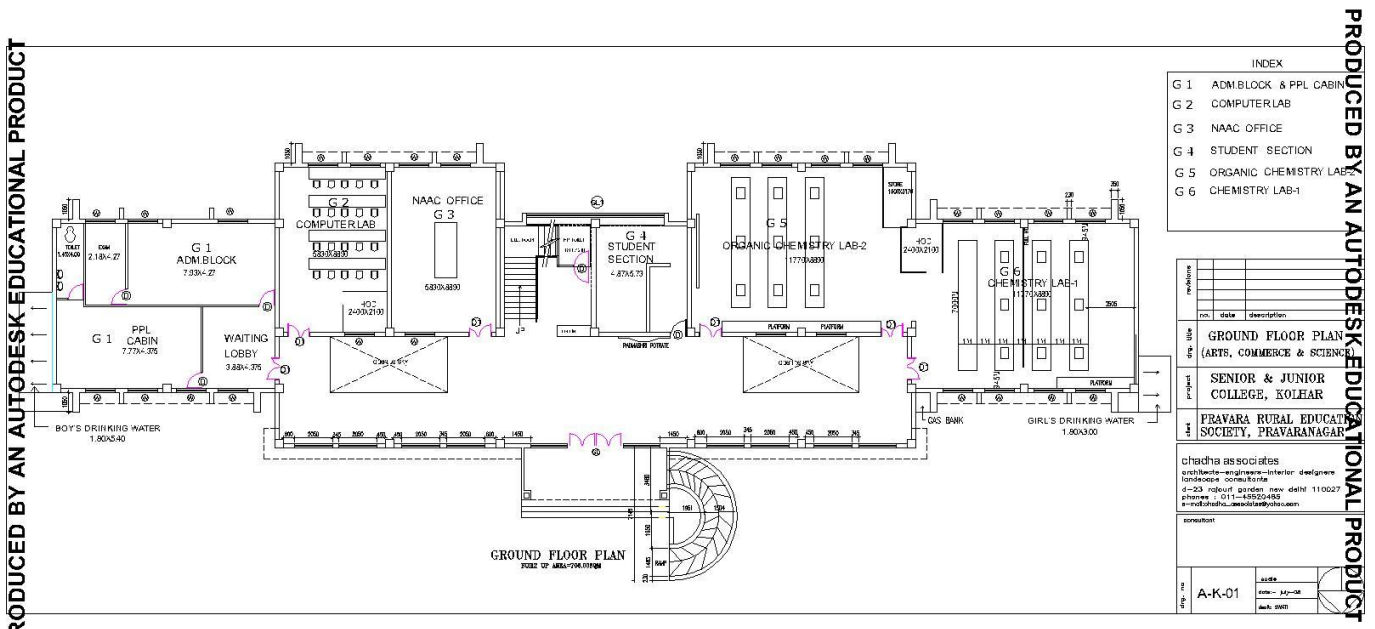

First Floor :

PRODUCED BY AN AUTODESK EDUCATIONAL PRODUCT

PRODUCED BY AN AUTODESK EDUCATIONAL PRODUCT

PRODUCED BY AN AUTODESK EDUCATIONAL PRODUCT

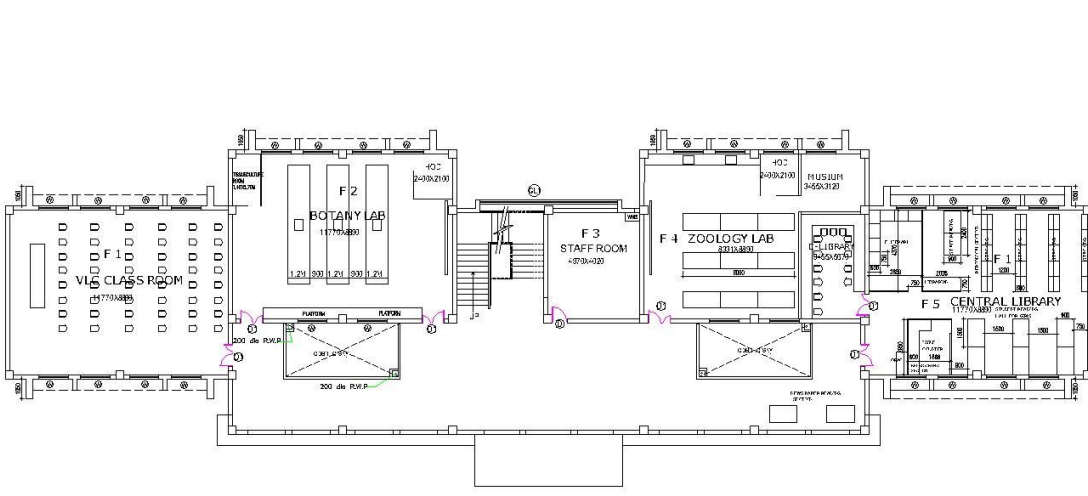

FIRST FLOOR PLAN

INDEX	
F1	VLC CLASS ROOM
F2	BOTANY LAB
F3	STAFF ROOM
F4	ZOOLOGY LAB
F5	CENTRAL LIBRARY

no.	date	description
FIRST FLOOR PLAN (ARTS, COMMERCE & SCIENCE)		
SENIOR & JUNIOR COLLEGE, KOLHAR		
PRAVARA RURAL EDUCATIONAL SOCIETY, PRAVARANAGAR		

chadha associates
 architects-engineers-interior designers
 landscape consultants
 d-23 rajpout garden new delhi 110027
 phone: +91-11-43522485
 e-mail: chadha_associates@yahoo.com

revision

no.	date	auth.
A-K-02	14-07-20	AK

Second Floor:

PRODUCED BY AN AUTODESK EDUCATIONAL PRODUCT

PRODUCED BY AN AUTODESK EDUCATIONAL PRODUCT

PRODUCED BY AN AUTODESK EDUCATIONAL PRODUCT

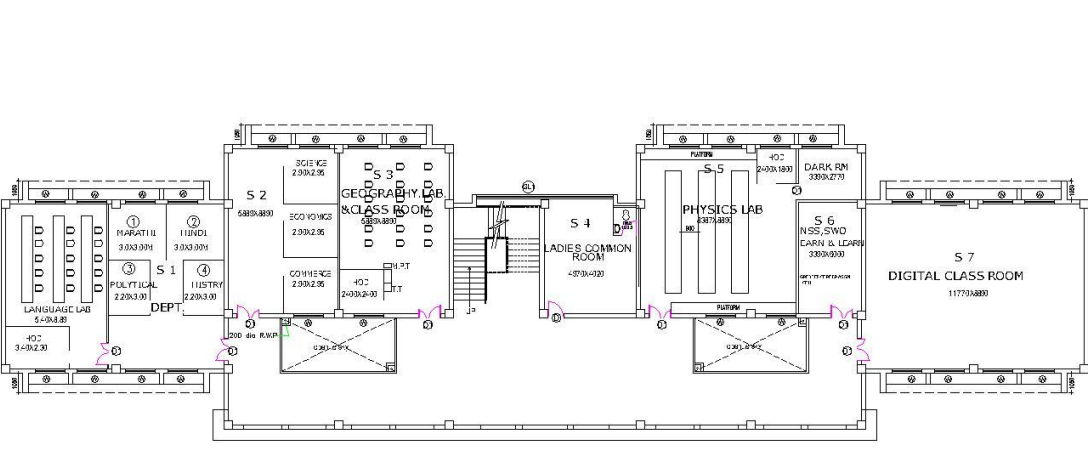

SECOND FLOOR PLAN

INDEX	
S 1	LANGUAGE LAB
S 2	GEOGRAPHY, LAB.
S 3	CLASS ROOM
S 4	LADIES COMMON ROOM
S 5	PHYSICS LAB
S 6	NSS, S.W.O & EARN & LEARN GREIVENCE REDRESSAL CELL
S 7	DIGITAL CLASS ROOM

no.	date	description
SECOND FLOOR PLAN (ARTS, COMMERCE & SCIENCE)		
SENIOR & JUNIOR COLLEGE, KOLHAR		
PRAVARA RURAL EDUCATIONAL SOCIETY, PRAVARANAGAR		

chadha associates
 architects-engineers-interior designers
 landscape consultants
 d-23 rajpout garden new delhi 110027
 phone: +91-11-43522485
 e-mail: chadha_associates@yahoo.com

revision

no.	date	auth.
A-K-03	14-07-20	AK



LOKNETE DR. BALASAHEB VIKHE PATIL
(PADMA BHUSHAN AWARDEE)
PRAVARA RURAL EDUCATION SOCIETY

ARTS, SCIENCE & COMMERCE COLLEGE KOLHAR

Tal. Rahata, Dist. Ahmednagar, Pin - 413 710
NAAC Accredited at 'A' Grade with CGPA 3.10

Institute Main Building



Hostel Facility



Gymnasium



Indore Gymnasium



Open Gymnasium



Sports Ground



R.O. Filter Plant & Drinking Water



Parking Shed





Cycle Stand



E-Bike Parking



Botanical Garden





Canteen



Solar System



Generator



Back up (Inverter) Facility





Latitude: 19.545968
Longitude: 74.526059
Elevation: 518.89±8 m
Accuracy: 56.0 m
Time: 25-11-2022 09:46
Note: Inverter- Library

Powered by NoteCam



Latitude: 19.545826
Longitude: 74.526218
Elevation: 518.84±17 m
Accuracy: 67.4 m
Time: 25-11-2022 09:43
Note: Inverter

Powered by NoteCam

Xerox Machine



Library



Library Reading Hall



Library Computer Lab



Library News Paper Reading



Library Web OPAC



Principal Office



IQAC

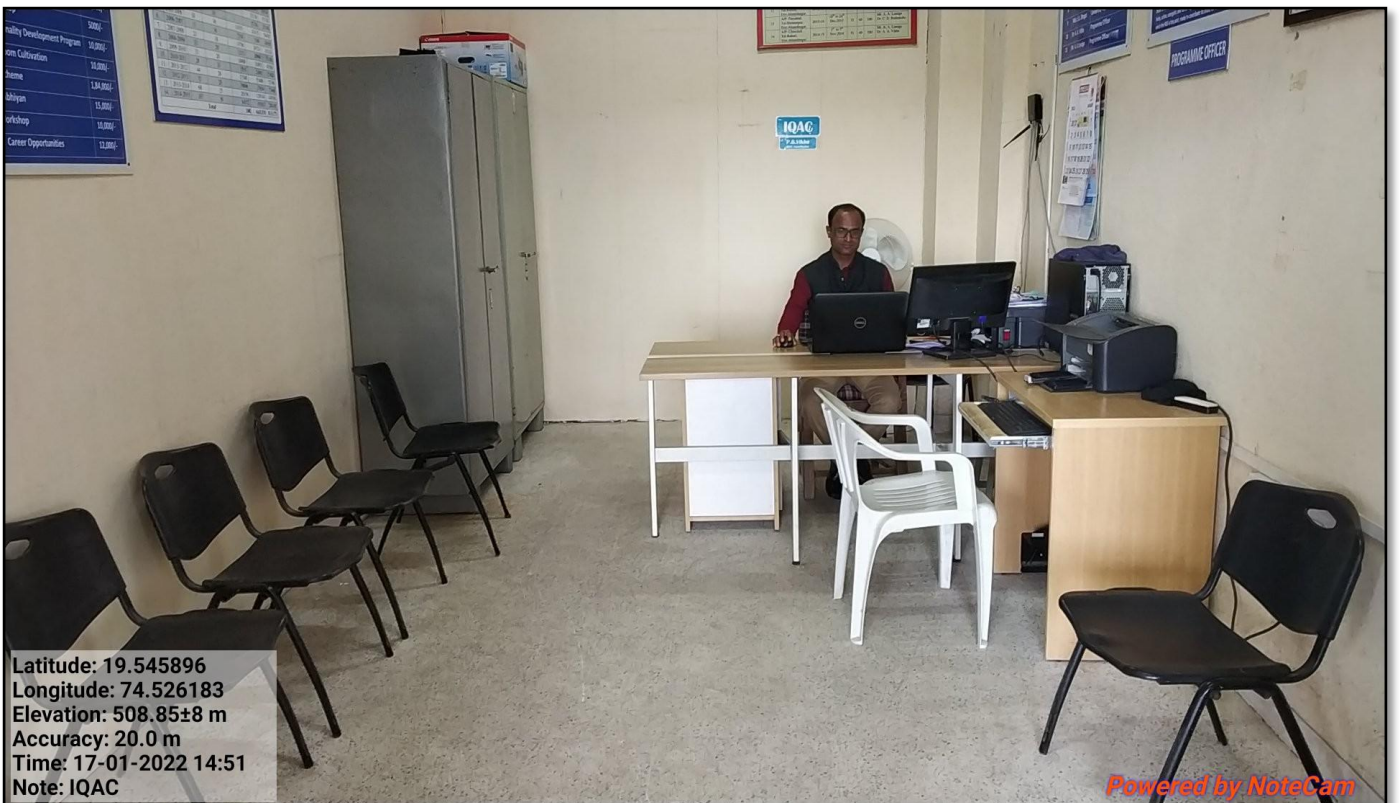

Computer Lab



Digital Language Lab

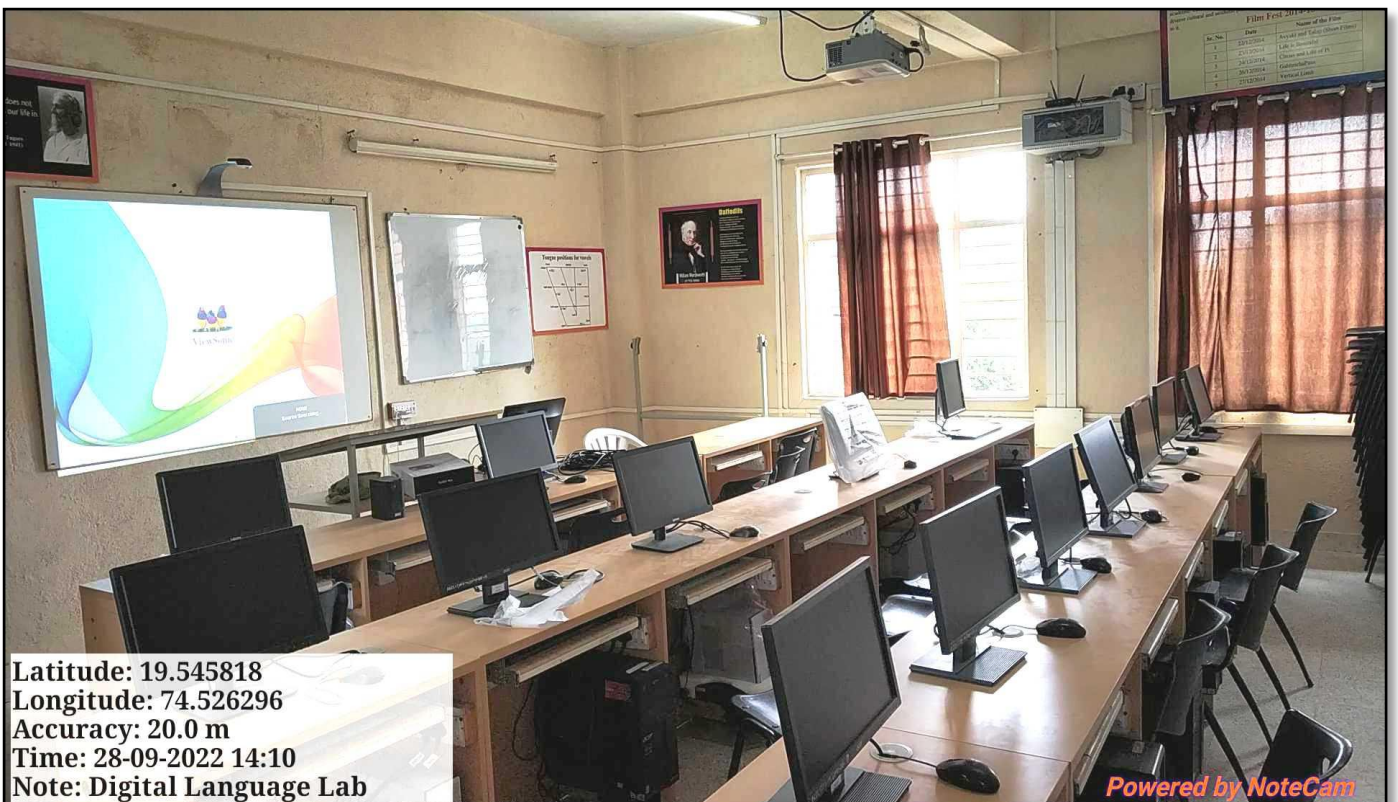

Digital Classroom

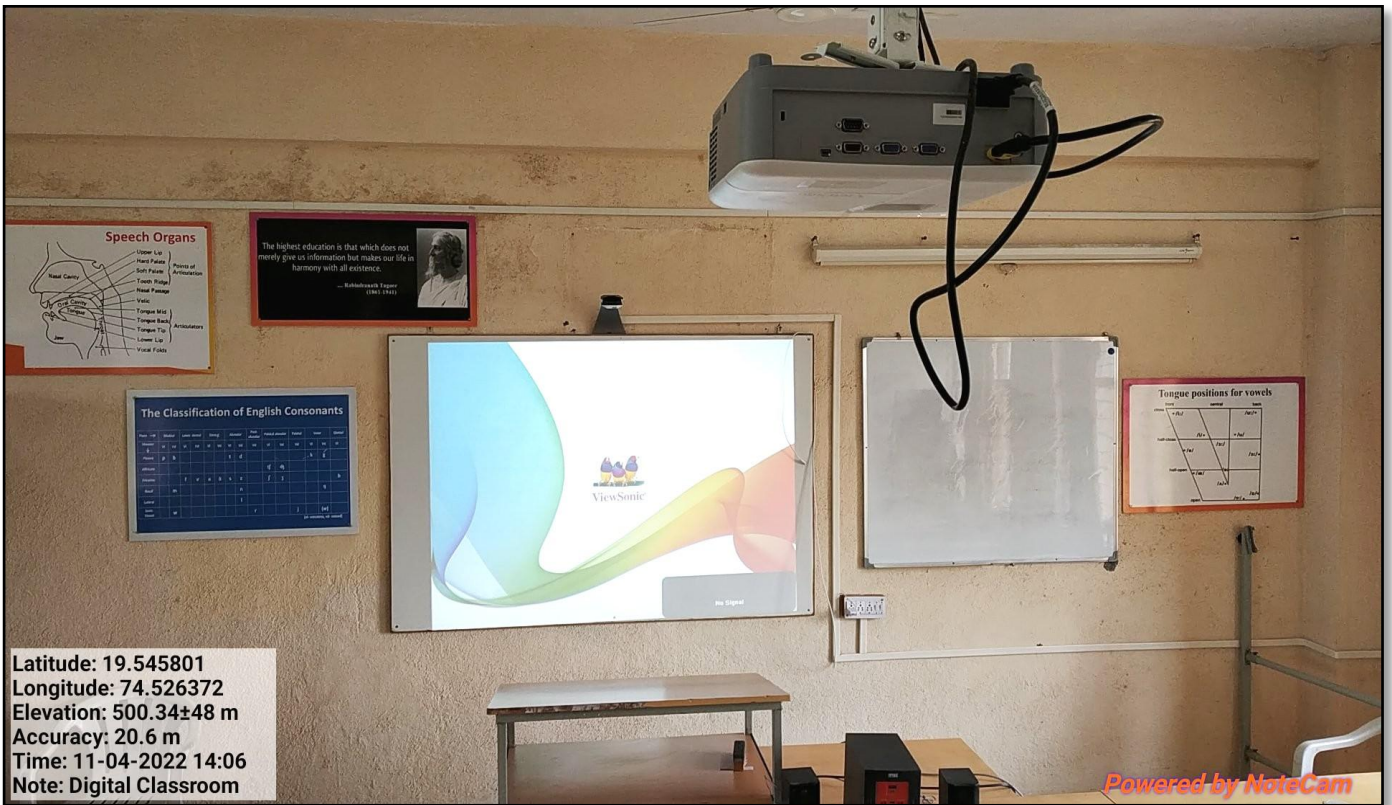

Staff Room & Meeting Hall



VLC Hall



Wi-Fi Facility

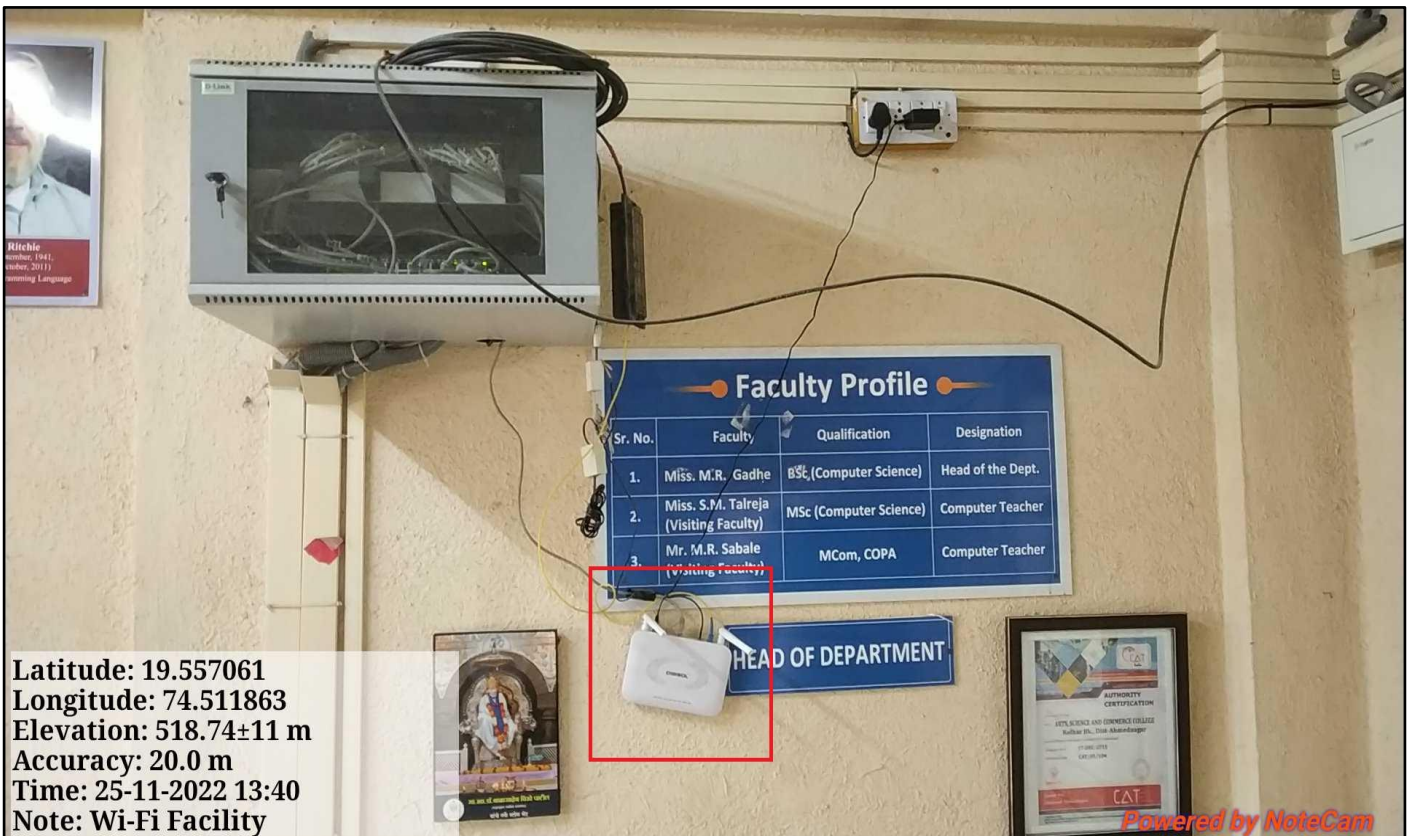



Botany Lab



Geography Lab

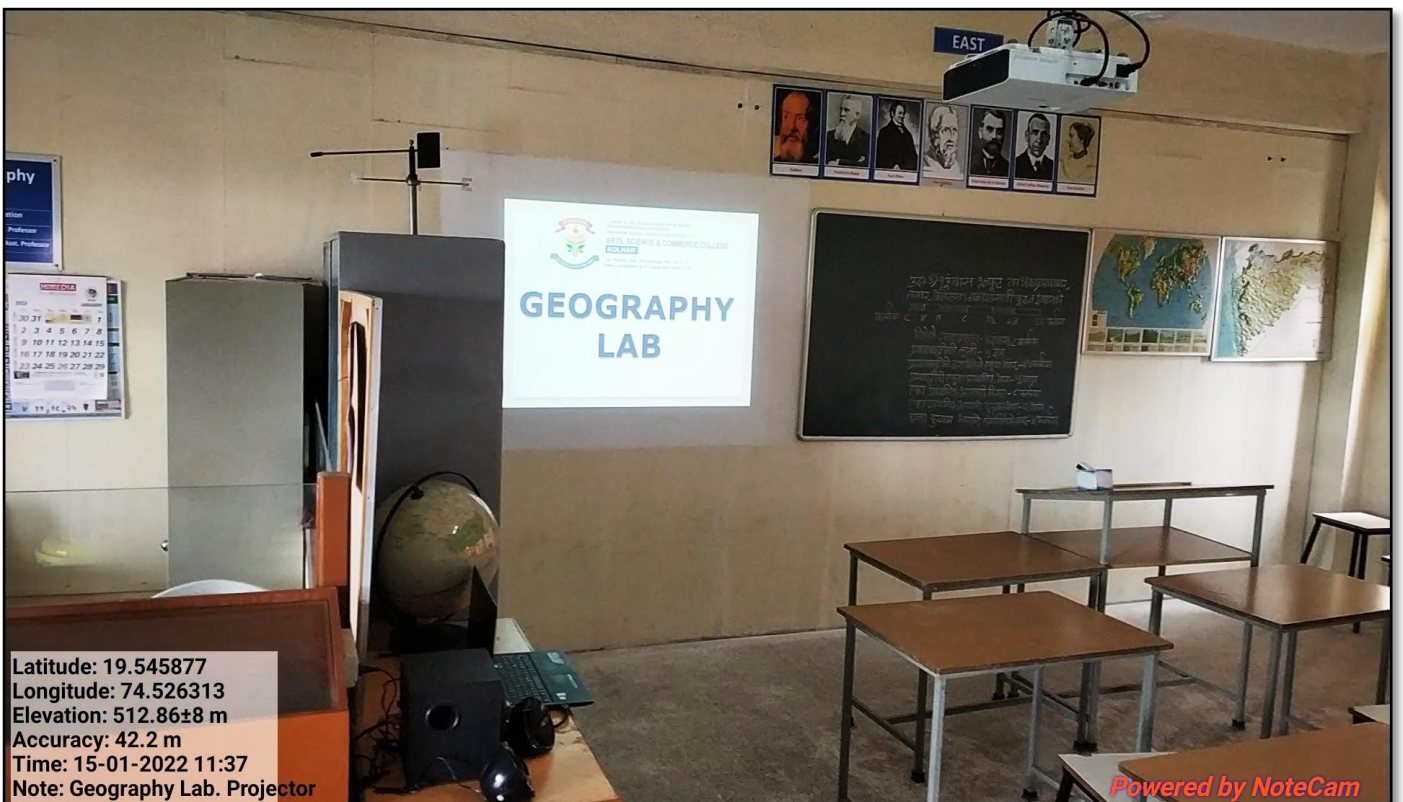

Physics Lab



Latitude: 19.545967
 Longitude: 74.526045
 Altitude: 450.9±2 m
 Accuracy: 20.0 m
 Time: 25-11-2022 10:07
 Note: Physics Lab

Powered by NoteCam



Latitude: 19.5459
 Longitude: 74.526183
 Elevation: 570.71±384 m
 Accuracy: 75.6 m
 Time: 15-01-2022 10:48
 Note: Physics Lab. Projecto

Powered by NoteCam

Zoology Lab



Department of Arts



Department of Commerce



Class Rooms







Latitude: 19.545904
Longitude: 74.526161
Elevation: 525.49±32 m
Accuracy: 40.9 m
Time: 15-01-2022 12:39
Note: Block No. T-5 : Projector

Powered by NoteCam

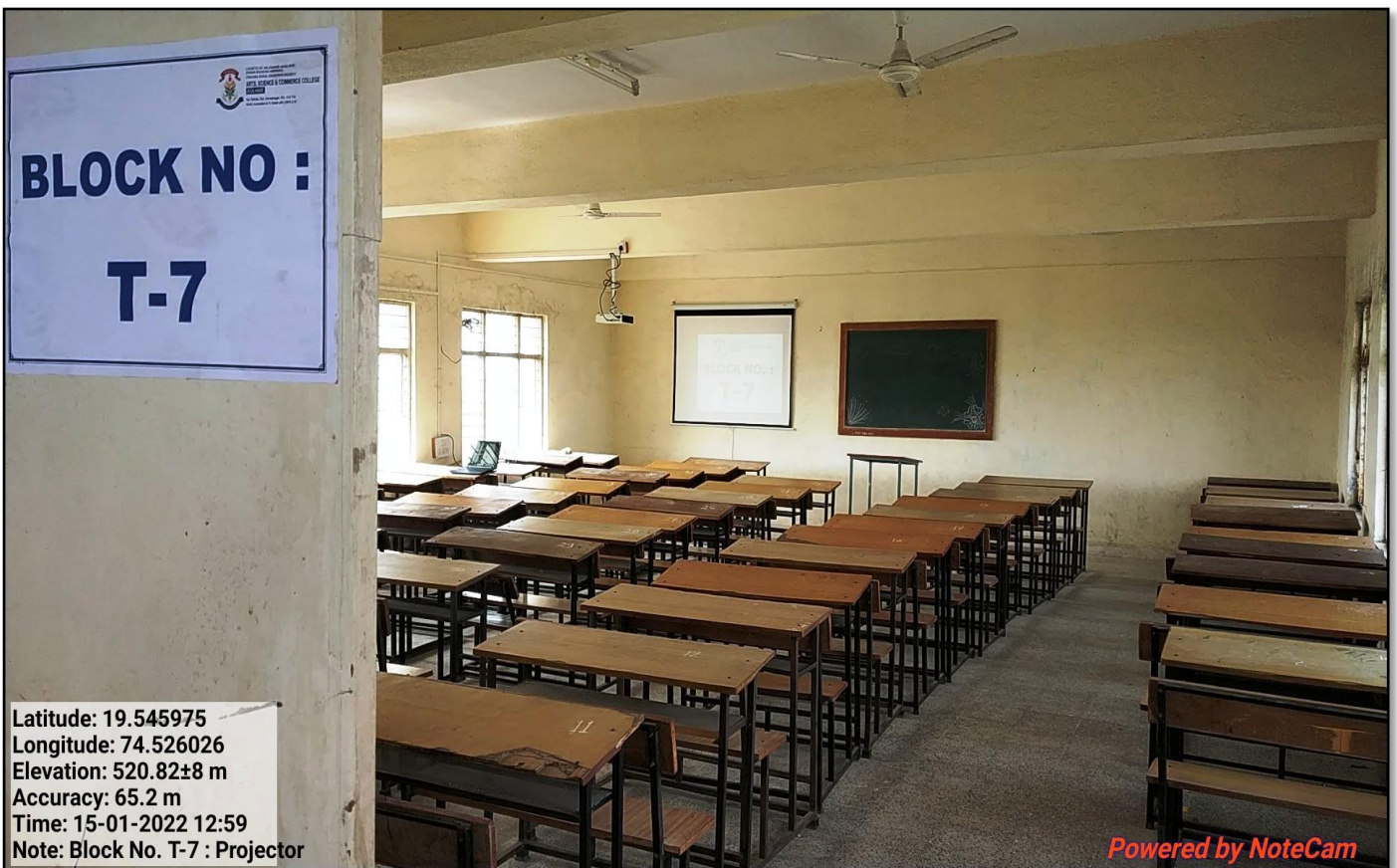

Latitude: 19.545975
Longitude: 74.526026
Elevation: 520.82±8 m
Accuracy: 65.2 m
Time: 15-01-2022 12:59
Note: Block No. T-7 : Projector

Powered by NoteCam



Gents Toilet



Latitude: 19.545916
Longitude: 74.526256
Elevation: 522.9±12 m
Accuracy: 43.7 m
Time: 17-01-2022 14:25
Note: Gents Toilet

Powered by NoteCam

Ladies Toilet



Sanitary Pad Machine



Disabled Student Ramp



Latitude: 19.546089
Longitude: 74.526065
Elevation: 534.49±12 m
Accuracy: 16.4 m
Time: 28-09-2022 16:11
Note: Disable Students Ramp

Powered by NoteCam

Security Office



Latitude: 19.544792
Longitude: 74.528097
Elevation: 484.87±12 m
Accuracy: 7.5 m
Time: 17-01-2022 14:35
Note: Security Office

Powered by NoteCam